

STANDARD CANOPY YAMUNA IP-175

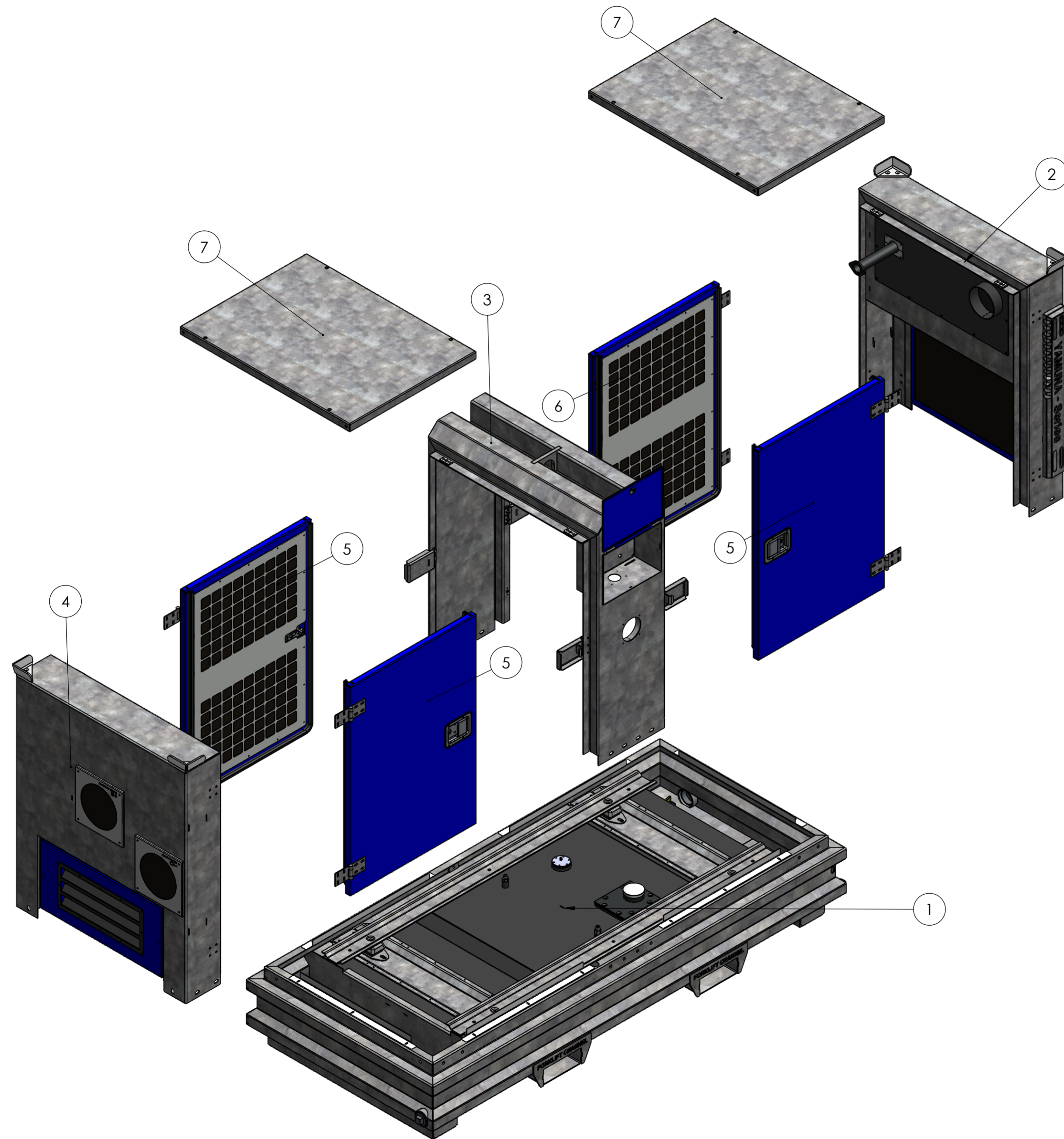

ITEM NO.	PART NUMBER	DESCRIPTION	QTY.
1	20494	UNDER BASE STANDARD CANOPY	1
2	20448	PANEL C STANDARD CANOPY YAMUNA	1
3	30841	MIDDLE PANEL STANDARD CANOPY VERSION II	1
4	20427	PANEL D STANDARD CANOPY YAMUNA	1
5	20380	DOOR WITH LOCKER 1010 mm x 705 mm COMPLETE	3
6	20423	DOOR WITHOUT LOCKER 1010 mm x 705 mm COMPLETE	1
7	20393	TOP PANEL CANOPY 945 mm x 705 mm	2

Revision information					UNSPECIFIED GEOMETRICAL, LINEAR AND ANGULAR TOLERANCE SHALL CONFORM TO ISO 2768-MK (UNLESS OTHERWISE STATED)			format	scale	projection	
Rev	Date	Drn	Appr	Info	A2	1:13	⊕				
H	28-07-2023	JG	JG	-	Drawn:	AK	web:		www.impulsebv.com		
G	24-07-2023	JG	JG	-	Date:	02-08-2022	Material:				
F	20-07-2023	JG	JG	-	Rev.:	H	Weight:		590.93 Kg		
E	19-07-2023	JG	JG	-	State:	Approved	Treatm.:		Assemble		
PDM No. : 20379					Title: STANDARD CANOPY IP-175 YAMUNA DIESEL						

All rights strictly reserved. Reproduction or issue to third parties in any form
 whatever is not permitted without written authority from the proprietor.
 Property of Impulse Holding B.V. Copyright Impulse Pumps E.V.