

A

B

C

D

E

F

A

B

C

D

E

F

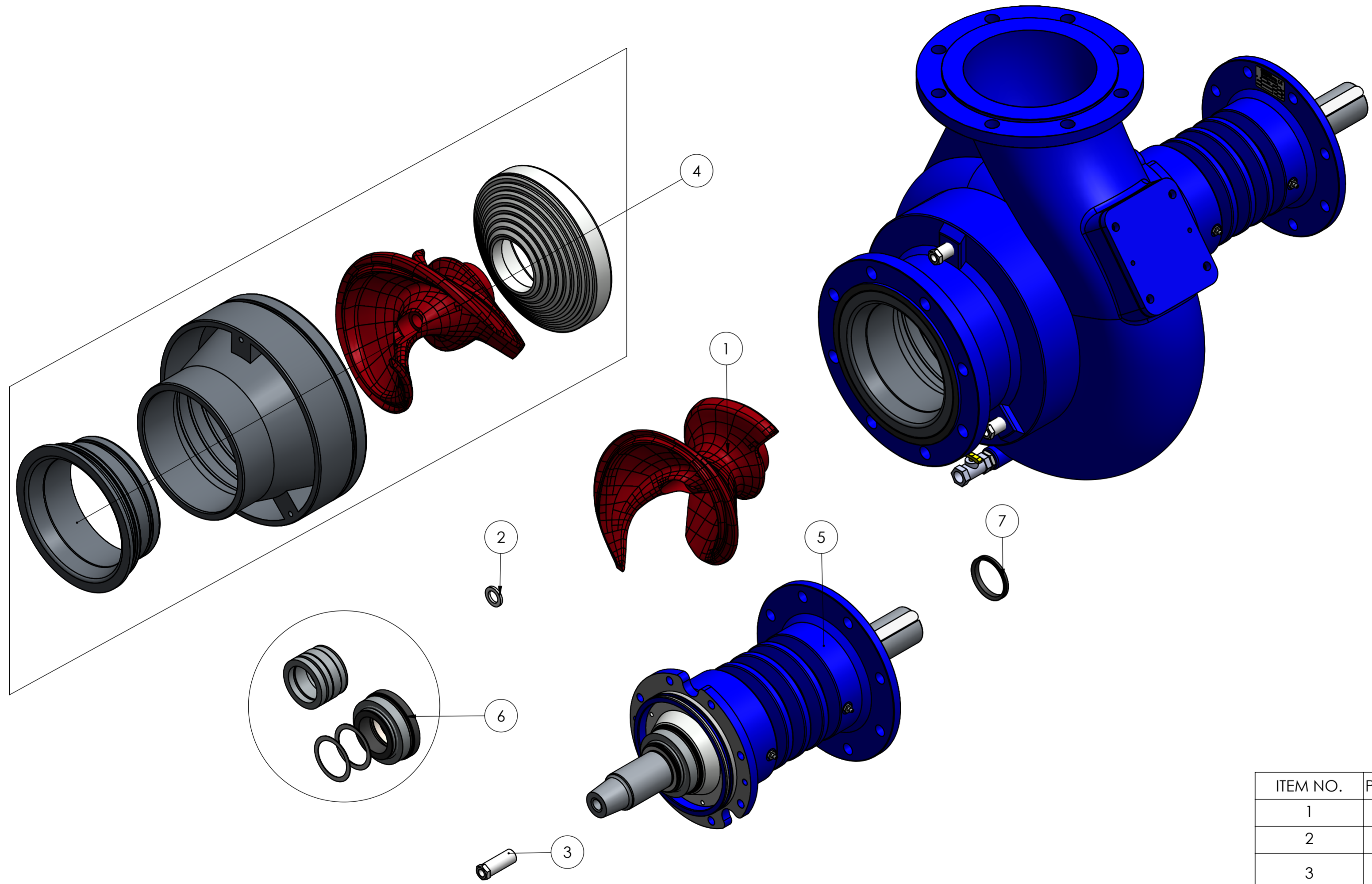

ITEM NO.	PART NUMBER	DESCRIPTION	QTY.
1	30787	Impeller SIP-200 8 inch	1
2	30819	Washer Impeller Bolt SIP-200/300	1
3	30818	Adjustment Screw Pump House SIP-200	3
4	33705	SIP 200-8 INTERNAL REPLACEMENT SET	1
5	30788	BEARING HOUSE REPLACEMENT SIP-200 (+BACKSEAL)	1
6	33703	SEAL SET SIP 200-300 SHAFT 60 mm	1
7	30812	V-ring NBR V-60 A	1

Revision information				UNSPECIFIED GEOMETRICAL, LINEAR AND ANGULAR TOLERANCE SHALL CONFORM TO ISO 2768-MK (UNLESS OTHERWISE STATED)			format	scale	projection	 Dewatering Technologies
Rev	Date	Drn	Appr	Info	A2	1:5				
-	13-06-2023		JG	-	Drawn:	JG	web: www.impulsebv.com			
					Date:	13-06-2023	Material:			
					Rev.:	-	Weight: 374.72 Kg			
					State:	Approved	Treatm.: Assemble			
PDM No. : 30782				Title: PUMP SIP-200 FREE SHAFT COMPLETE						

All rights strictly reserved. Reproduction or issue to third parties in any form
 whatever is not permitted without written authority from the proprietor.
 Property of Impulse Holding B.V. Copyright Impulse Pumps E.V.