

ORIENTAL STANDARD CANOPY SPAREPARTS

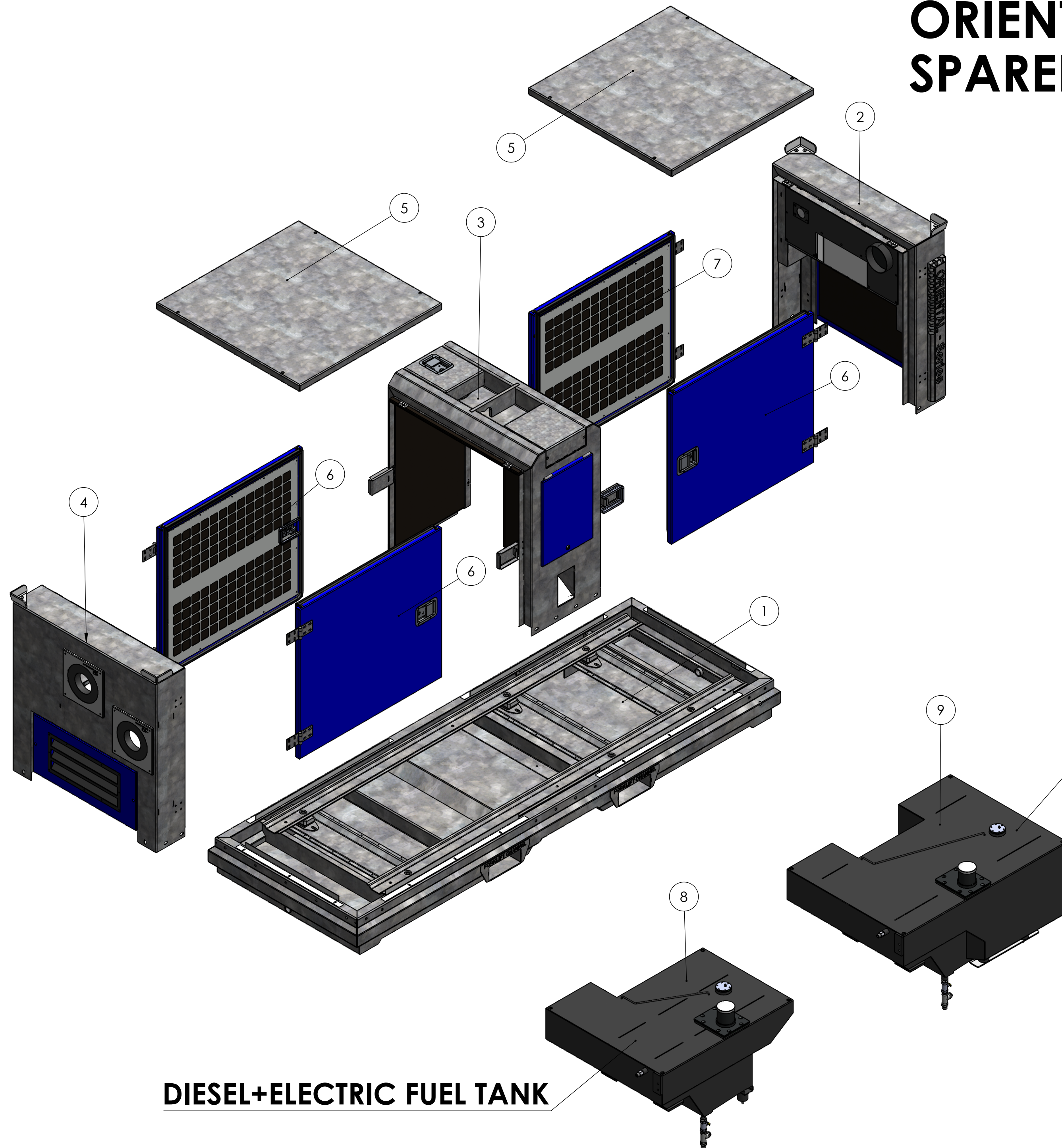

DIESEL ONLY FUEL TANK

| ITEM NO. | PART NUMBER | DESCRIPTION | QTY. |
|----------|-------------|---|------|
| 1 | 31998 | UNDER BASE CANOPY ORIENTAL | 1 |
| 2 | 32008 | PANEL C STANDARD CANOPY ORIENTAL | 1 |
| 3 | 32009 | MIDDLE PANEL STANDARD CANOPY ORIENTAL | 1 |
| 4 | 32010 | PANEL D STANDARD CANOPY ORIENTAL | 1 |
| 5 | 32011 | TOP PANEL CANOPY ORIENTAL 947 mm x 940 mm | 2 |
| 6 | 32012 | DOOR WITH LOCKER 940 mm x 855 mm COMPLETE ORIENTAL | 3 |
| 7 | 32013 | DOOR WITHOUT LOCKER 940 mm x 855 mm COMPLETE ORIENTAL | 1 |
| 8 | 32095 | FUEL TANK ORIENTAL DIESEL-ELECTRIC | 1 |
| 9 | 32224 | FUEL TANK ORIENTAL DIESEL | 1 |

DIESEL+ELECTRIC FUEL TANK

| Revision information | | | | | UNSPECIFIED GEOMETRICAL, LINEAR AND ANGULAR TOLERANCE SHALL CONFORM TO ISO 2768-MK (UNLESS OTHERWISE STATED) | | | format | scale | projection | |
|------------------------|------------|-----|------|------|--|------------|---|--------|-------|------------|--|
| Rev | Date | Drn | Appr | Info | A2 | 1:14 | ⊕ | ⊖ | | | |
| H | 31-08-2023 | JG | JG | - | Drawn: | A | web: www.impulsebv.com | | | | |
| G | 24-07-2023 | JG | JG | - | Date: | 11-07-2022 | Material: | | | | |
| F | 19-07-2023 | JG | JG | - | Rev.: | H | Weight: 649.73 Kg | | | | |
| E | 21-11-2022 | JG | JG | - | State: | Approved | Treatm.: Assemble | | | | |
| PDM No. : 32004 | | | | | Title: STANDARD CANOPY IP-175 ORIENTAL | | | | | | |

All rights strictly reserved. Reproduction or issue to third parties in any form whatever is not permitted without written authority from the proprietor. Property of Impulse Holding B.V. Copyright Impulse Pumps E.V.