

MEDIUM CANOPY SIP 200-8 HATZ 4H50

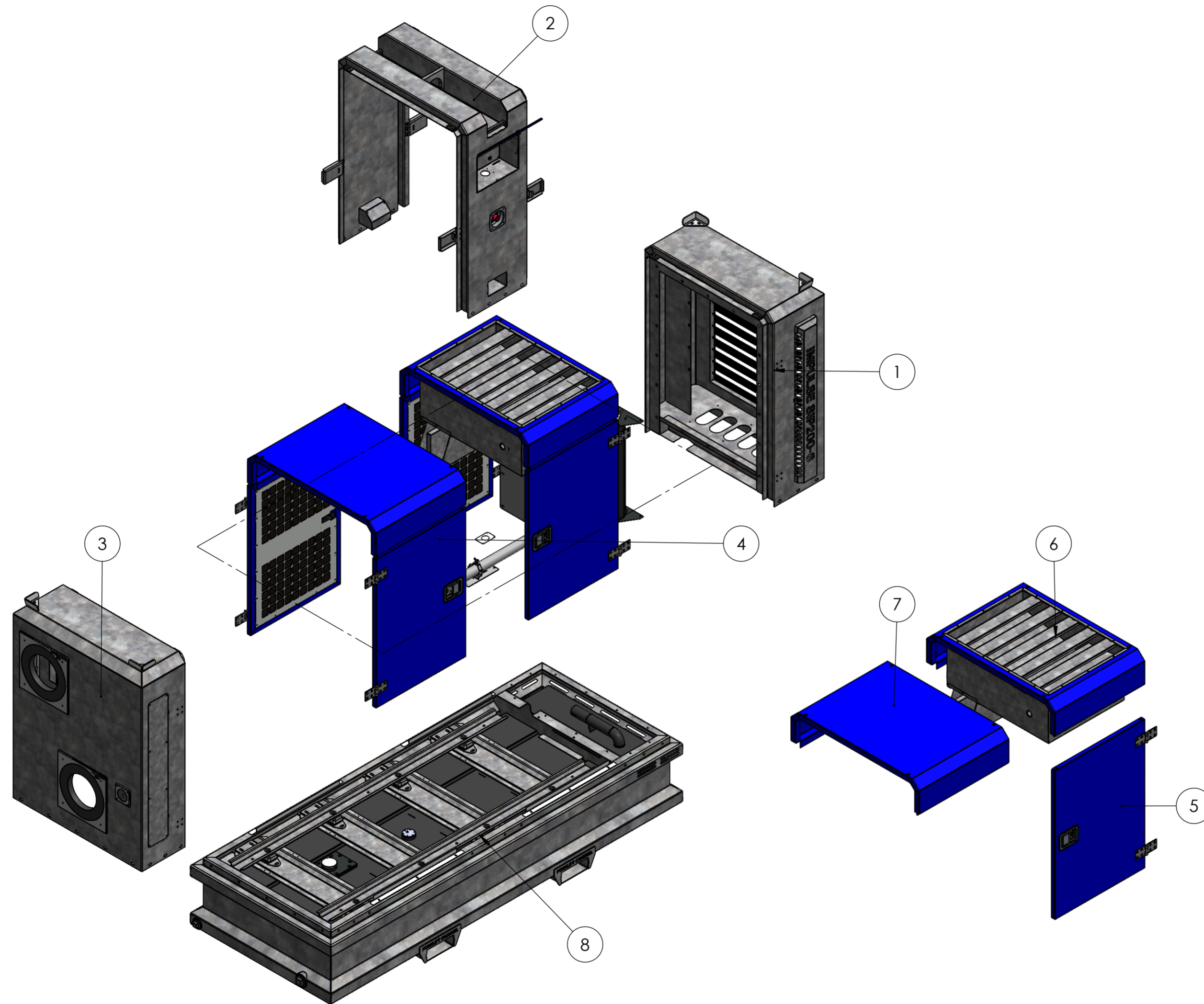

ITEM NO.	PART NUMBER	DESCRIPTION	QTY.
1	32922	PANEL C STANDARD SIP-200-8	1
2	32945	MIDDLE PANEL MEDIUM CANOPY COMPLETE (PV700)	1
3	30337	PANEL D STANDARD SIP-200	1
4	33812	PANEL SET MEDIUM CANOPY SIP 200-8 HATZ 4M41	1
5	20380	DOOR WITH LOCKER 1010 mm x 705 mm COMPLETE	1
6	30339	TOP PANEL EXHAUST SIP-200	1
7	30338	WELD ASSY TOP PANEL SIP-200	1
8	32865	UNDER BASE SIP-200 COMPLETE	1

Revision information					UNSPECIFIED GEOMETRICAL, LINEAR AND ANGULAR TOLERANCE SHALL CONFORM TO ISO 2768-MK (UNLESS OTHERWISE STATED)			format	scale	projection	
Rev	Date	Drn	Appr	Info	A2	1:20	⊕	⊖			
-	17-07-2023	JG	-		Drawn:	JG			web:	www.impulsebv.com	
					Date:	17-07-2023			Material:		
					Rev.:	-			Weight:	1044.82 Kg	
					State:	Approved			Treatm.:	Assemble	
PDM No. : 32851					Title: MEDIUM CANOPY SIP-200 HATZ 4H50						

All rights strictly reserved. Reproduction or issue to third parties in any form
 whatever is not permitted without written authority from the proprietor.
 Property of Impulse Holding B.V. Copyright Impulse Pumps E.V.