

# SIP 150-6 SPAREPART LIST

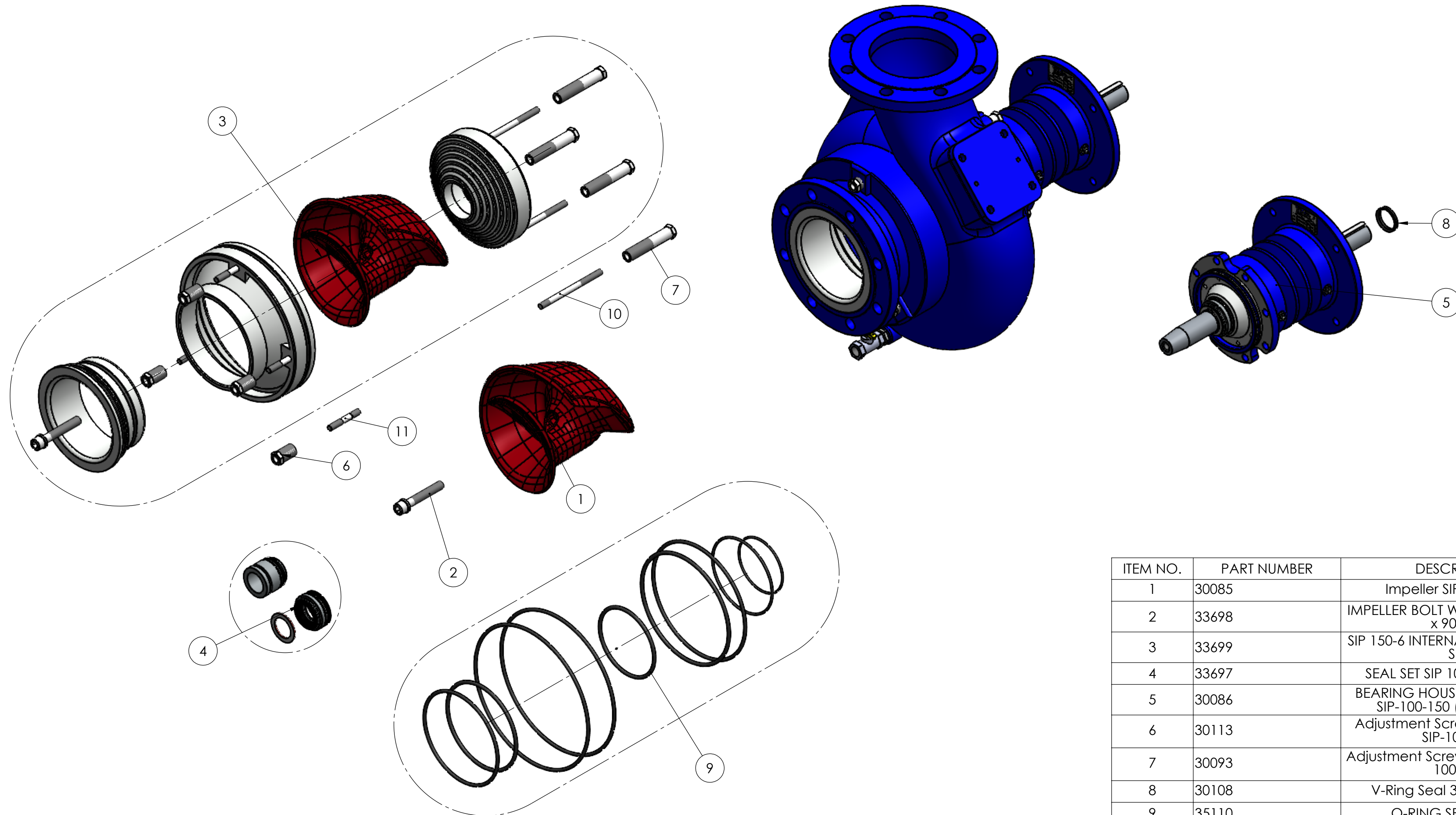

ITEM NO.	PART NUMBER	DESCRIPTION	QTY.
1	30085	Impeller SIP-150 6 inch	1
2	33698	IMPELLER BOLT WITH WASHER M14 x 90 mm	1
3	33699	SIP 150-6 INTERNAL REPLACEMENT SET	1
4	33697	SEAL SET SIP 100-4 / SIP 150-6	1
5	30086	BEARING HOUSE REPLACEMENT SIP-100-150 (+BACKSEAL)	1
6	30113	Adjustment Screw Pump House SIP-100-150	1
7	30093	Adjustment Screw Back Cone SIP-100-150	1
8	30108	V-Ring Seal 38 x 55 x 9 mm	1
9	35110	O-RING SET SIP 150-6	1
10	33271	Stud Bolt M10 x 140-50-20	1
11	34058	Stud M10x70 28-20	1

Revision information					UNSPECIFIED GEOMETRICAL, LINEAR AND ANGULAR TOLERANCE SHALL CONFORM TO ISO 2768-MK (UNLESS OTHERWISE STATED)			format	scale	projection	
Rev	Date	Drn	Appr	Info	A2	1:5	⊕	⊖	⊖		
A	21-01-2025	JG	JG	-	Drawn:	JG	web:		www.impulsebv.com		
-	20-01-2025	JG	-	-	Date:	10-01-2025	Material:				
					Rev.:	A	Weight:		183.72 Kg		
					State:	Approved	Treatm.:		Assemble		
<b>PDM No. : 35086</b>					<b>Title: SIP-150 PUMP - EXPLODED VIEW</b>						

All rights strictly reserved. Reproduction or issue to third parties in any form  
 whatever is not permitted without written authority from the proprietor.  
 Property of Impulse Holding B.V. Copyright Impulse Pumps E.V.